

APEM

www.apem.com

APEM RELEASES A NEW MINIATURE, FULLY SEALED ROCKER SWITCH
ERGONOMICALLY DESIGNED FOR EFFORTLESS FORWARD/REVERSE CONTROL.
EASY INTEGRATION AND MAXIMUM COMFORT.

FNR Series

APEM's new FNR rocker switch:
Maximized user comfort without
compromised efficiency.

PANEL
SWITCHES

PCB SWITCHES

LED INDICATORS

JOYSTICKS

SWITCH PANELS

CORE TARGETS

FNR SERIES IS IDEALLY SUITED FOR
HARSH ENVIRONMENTS AND ALL-IN-ONE
JOYSTICK CONTROLS.



FNR SERIES

SEALED ROCKER SWITCHES

CUSTOMER BENEFITS

- High sealing level for applications in harsh environments
- Very easy integration and mounting: Drop-in mounting, circular shape (\varnothing 20 mm) and embedded LED resistors
- Dedicated grip integration for joysticks front faceplates
- SIL2 capable: the FNR series rocker switches will help you reach the safety level required by your final application
- High B10d: with a B10d value of 1 million, the FNR series rocker switches ensure a very low potential failure rate

END-USER EXPERIENCE

- Clear status indicator: the rocker position and/or backlit symbol ensures clear status visibility of the function in use
- Optimized ergonomics and excellent tactile response: comfortable and efficient, even with extended use

CUSTOMIZATION POSSIBILITIES

- Backlighting: 5 colors available + dual colors
- Markings
- Additional sealing
- Wire output (type, length), connectors



TECHNICAL FEATURES

- SIL2 capable
- High B10d cycle value
- IP69K
- Embedded LED resistors
- Fixed or momentary positions
- Flying leads, solder lug or connector outputs

→ Flat

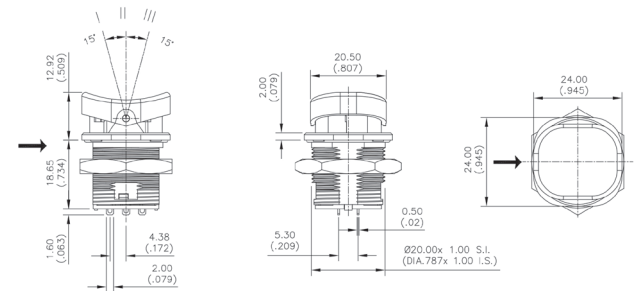

[Visit the product web page](#)

[Download the datasheet](#)

CONTACTS

BENELUX +32 27 25 05 00 - sales@apem.be
CHINA +86 21 6076 1355 - apem@apem.com.cn
DENMARK +45 44 97 33 66 - danmec@mec.dk
FRANCE +33 563931498 - commercial@apem.fr
GERMANY +49 8945991133 - info@apem.de

ITALY +39 0172 74 3170 - apem.italia@apem.it
SWEDEN +46 8 626 38 00 - info@apem.se
UNITED KINGDOM +44 1 844 202400 - sales@apem.co.uk
USA - HAVERHILL 1-978-372-1602 - info@apem.com
USA - VISTA 1-760-598-2518 - info@apem.com

 **APEM**
an IDEC company

www.apem.com